

BUILDING FINALIST

BE AWARDS
OF EXCELLENCE

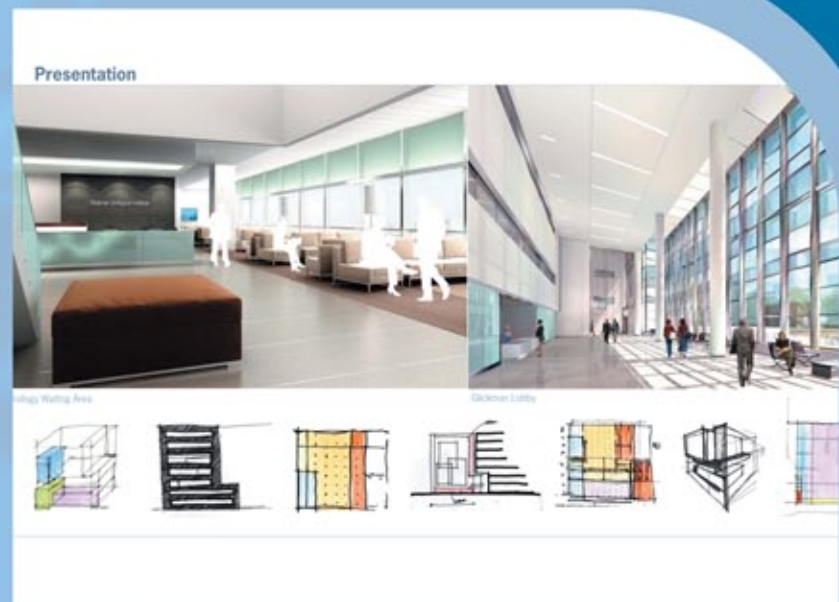

BIM FOR MULTIPLE DISCIPLINES

The Glickman Tower is a 325,000 square-foot outpatient building on the main campus of the Cleveland Clinic near downtown Cleveland, Ohio. The project consists of 10 above-grade habitable floors, a habitable basement, and a two-story mechanical penthouse, and is topped by a helipad. The largest challenge was the extremely fast track of the project, which needed to be completed simultaneously with a building that entered design more than four years earlier.

Because of the need for speed and efficiency, the decision was made to use BIM – specifically, the TriForma extension of MicroStation, Bentley Structural, and Bentley's RAM product line. Bentley's integrated BIM solutions were chosen because they provided the ability to extract 2D drawings from a 3D model as well as a robust rendering engine, and support a collaborative team environment.

Glickman Tower

NBBJ and Korda Nemeth